

- Existing 3315 Transmission Line (To Be Removed)
- Proposed 3315 Transmission Line
- Proposed Waterford Sub Tap Line

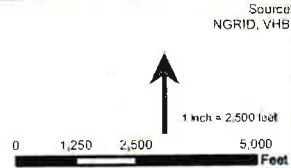

Source:
NGRID, VHB

NATIONAL GRID - REFURBISHMENT PROJECT

Project Overview Map - NH Side
2/2/2015

Removal of Existing 3315 Line & Proposed 3315 Line
3315 Asset Condition Refurbishment
Littleton and Monroe, NH & Barnet and Waterford, VT

nationalgrid



CONFIDENTIALITY STATEMENT: THIS DOCUMENT CONTAINS CONFIDENTIAL AND PROPRIETARY INFORMATION OF NATIONAL GRID. IT IS TO BE USED BY AUTHORIZED CONTRACTORS FOR NATIONAL GRID SOLELY IN CONNECTION WITH THE SPECIFIC PROJECT FOR WHICH IT HAS BEEN TRANSMITTED. ANY OTHER USE, ITS TRANSMITTAL TO THIRD PARTIES, OR ITS REPRODUCTION WITHOUT PRIOR EXPRESS WRITTEN AUTHORIZATION OF NATIONAL GRID IS STRICTLY PROHIBITED.

VER	DATE	VERSION DESCRIPTION	PREPARED	REVIEWED	APPROVED	VERSION
1	1.23.15	ISSUED FOR PERMITTING.	CAI/UDB	CAI/SMH	CAI/JFM	1
2						
3						
4						

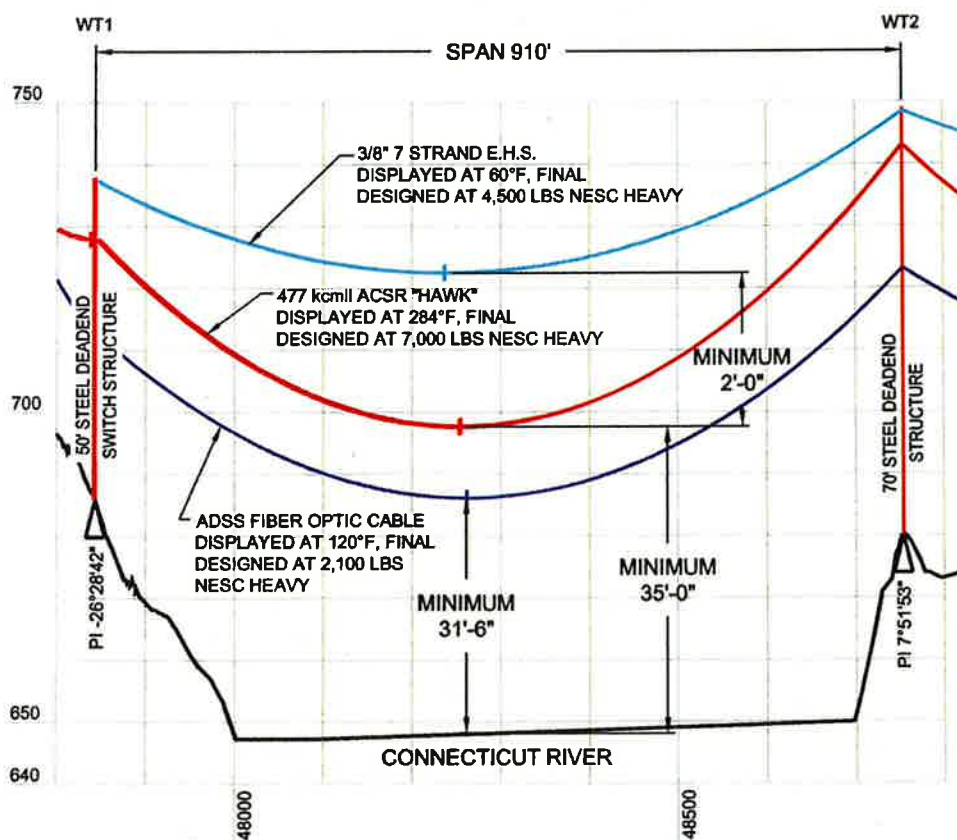
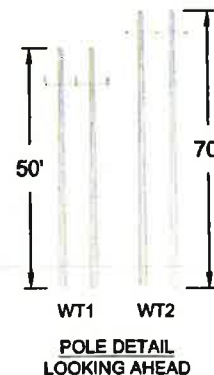
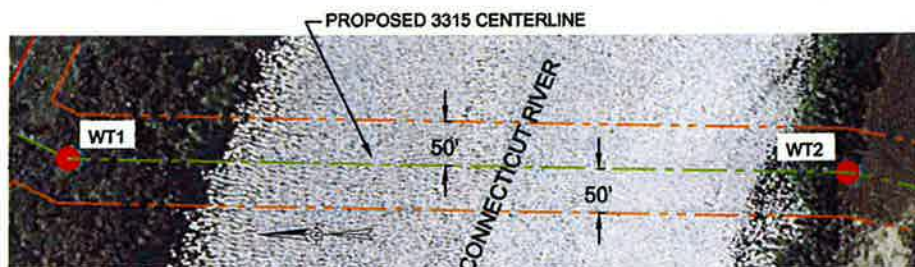

3315 MOORE TO COMERFORD
34.5kV TRANSMISSION LINE
CONNECTICUT RIVER
CROSSING SPAN WT1-WT2

PREPARED BY	UDB	1.08.15
REVIEWED BY	SMH	1.08.15
APPROVED BY	JFM	1.08.15
SCALE	N.T.S.	
SHEET	1	OF 1
INDEX	400236	

nationalgrid

400236-C-L-01

CONFIDENTIALITY STATEMENT: THIS DOCUMENT CONTAINS CONFIDENTIAL AND PROPRIETARY INFORMATION OF NATIONAL GRID. IT IS TO BE USED BY AUTHORIZED CONTRACTORS FOR NATIONAL GRID SOLELY IN CONNECTION WITH THE SPECIFIC PROJECT FOR WHICH IT HAS BEEN TRANSMITTED. ANY OTHER USE, ITS REPRODUCTION WITHOUT PRIOR EXPRESS WRITTEN AUTHORIZATION OF NATIONAL GRID IS STRICTLY PROHIBITED.

VER	DATE	VERSION DESCRIPTION	PREPARED	REVIEWED	APPROVED	VERSION
1	1.23.15	ISSUED FOR PERMITTING.	CAI/UDB	CAI/SMH	CAI/JFM	1
2						
3						
4						

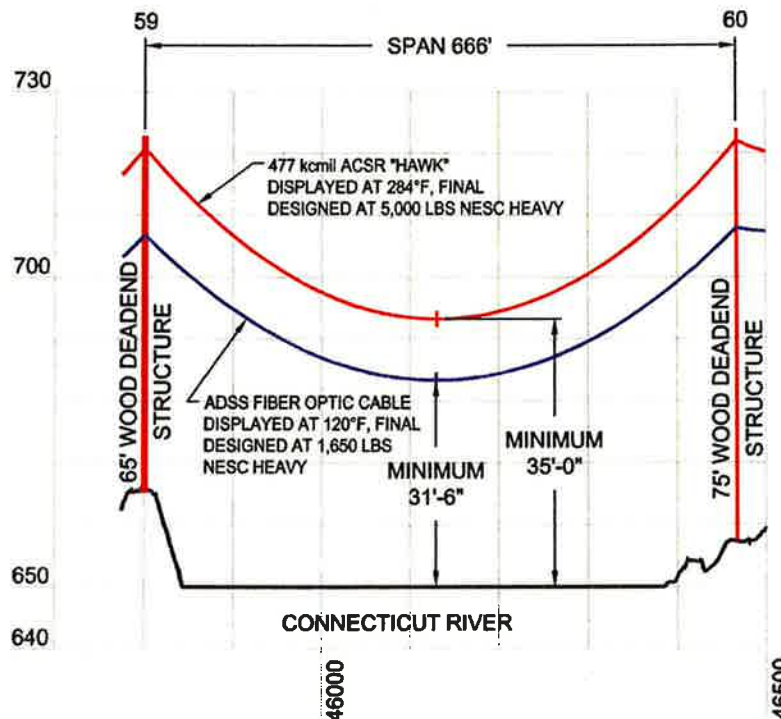
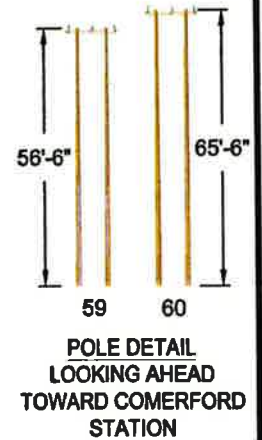
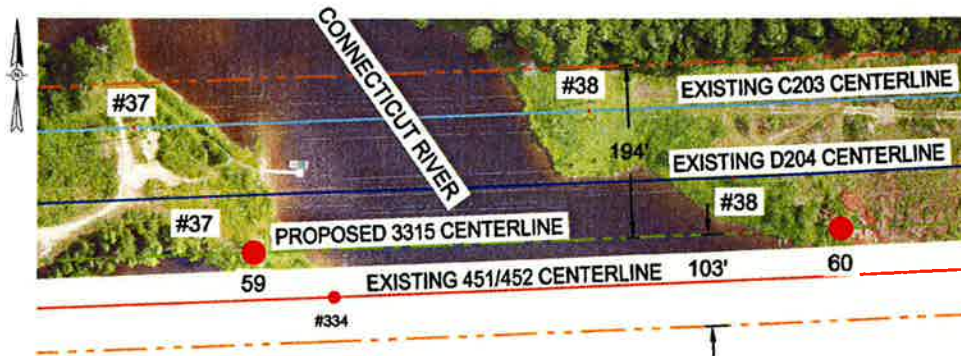

3315 MOORE TO COMERFORD
34.5kV TRANSMISSION LINE
CONNECTICUT RIVER
CROSSING SPAN 59-60

PREPARED BY	UDB	1.08.15
REVIEWED BY	SMH	1.08.15
APPROVED BY	JFM	1.08.15
SCALE	N.T.S.	
SHEET	1 OF 1	
INDEX	400236	

nationalgrid

400236-C-L-02

PRINTED 1/27/2015 8:43 AM

PRINTED COPIES ARE NOT DOCUMENT CONTROLLED. FOR THE LATEST AUTHORIZED VERSION PLEASE REFER TO THE ENGINEERING DEPARTMENT DOCUMENTS CABINET IN DOCUMENTUM